

Loads: BLC 1, dead

Roof Dead Load

Main Residence - 2

Mar 18, 2022 at 9:59 AM

mist model 2-26-22.r3d

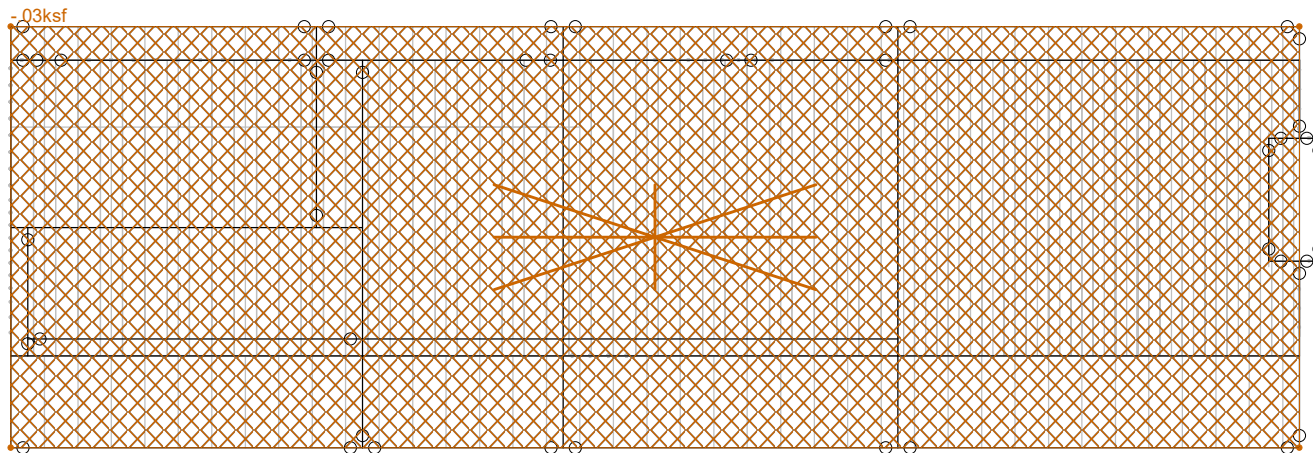

Loads: BLC 2, snow

Rood Snow Load

Main Residence - 3

Mar 18, 2022 at 10:00 AM

mist model 2-26-22.r3d

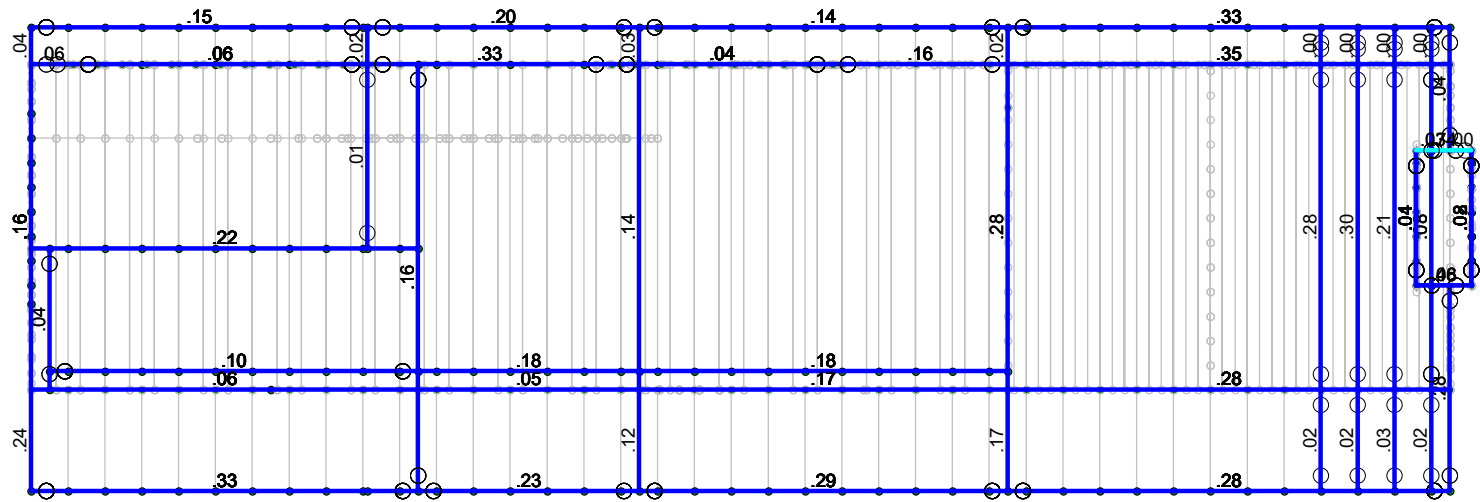
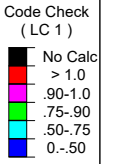

Member Code Checks Displayed
Results for LC 1, d+sn

Roof Member Stress Check

Main Residence - 4

Mar 18, 2022 at 10:05 AM

mist model 2-26-22.r3d

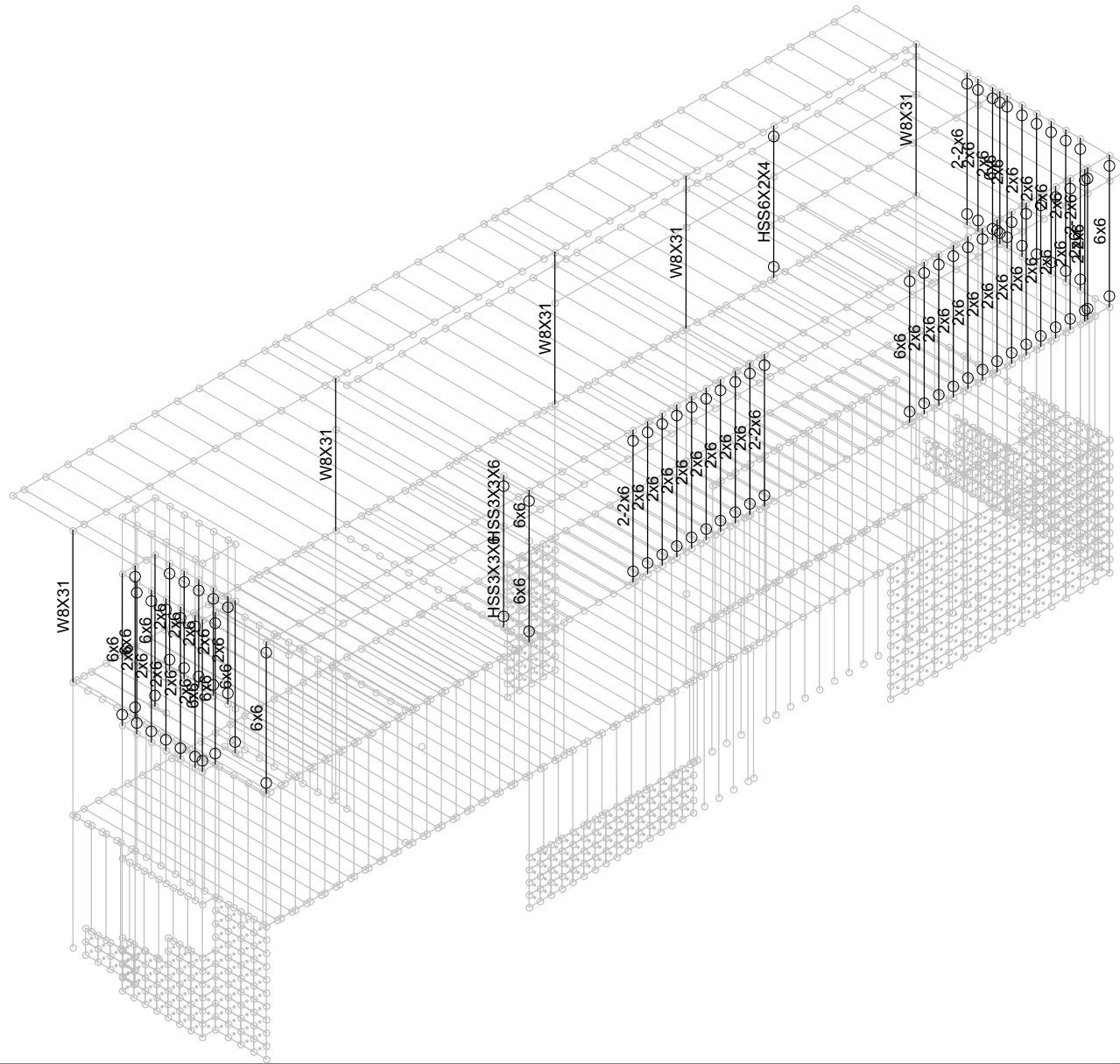
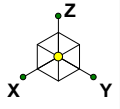

2nd Floor to Roof Vertical Member Sizes

Main Residence - 5

Mar 18, 2022 at 10:10 AM

mist model 2-26-22.r3d

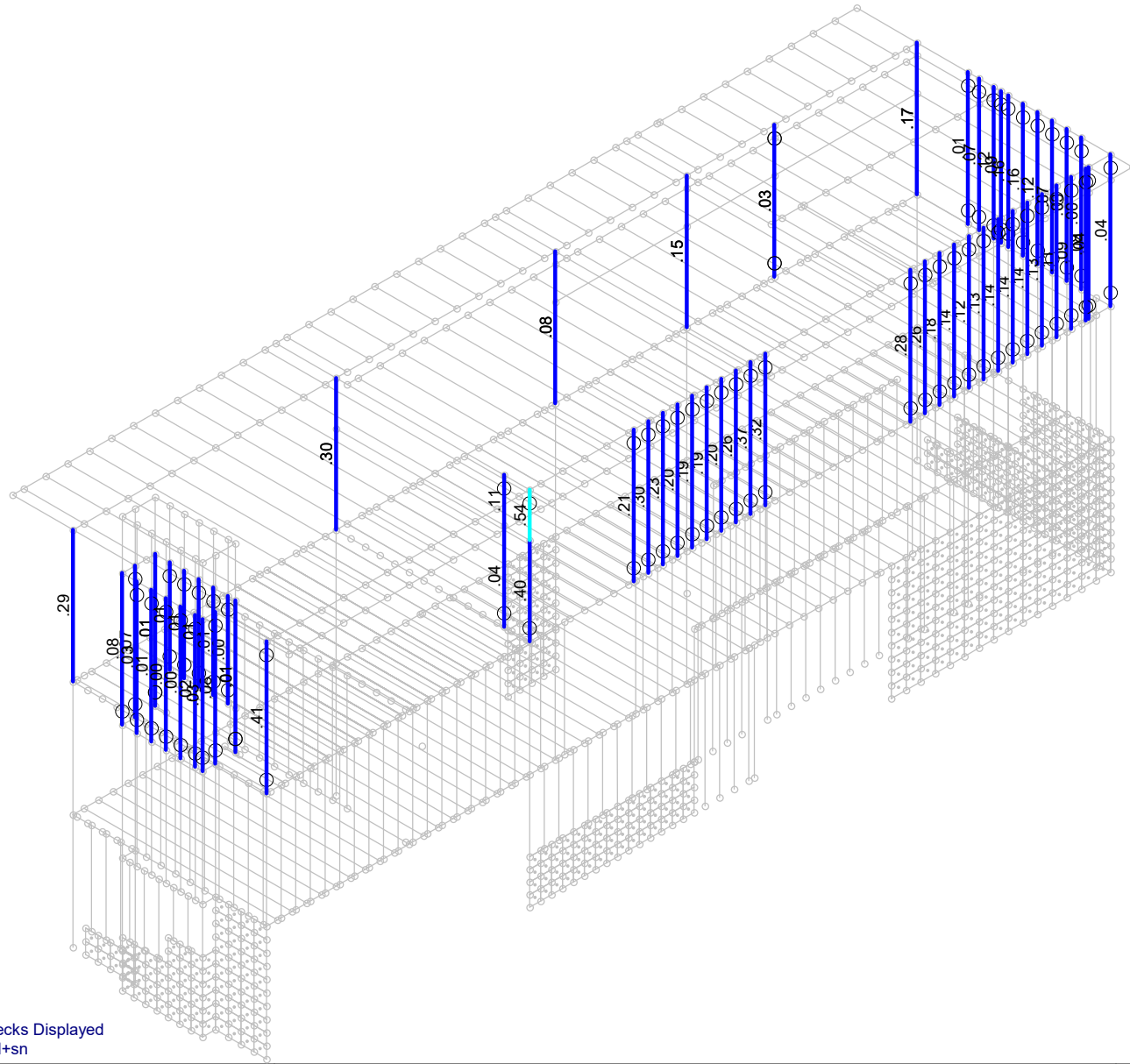
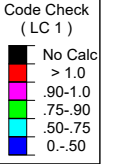
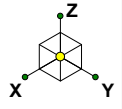

Member Code Checks Displayed
Results for LC 1, d+s+n

2nd Floor to Roof Vertical Member Stress Check

Main Residence - 6

Mar 18, 2022 at 10:11 AM

mist model 2-26-22.r3d

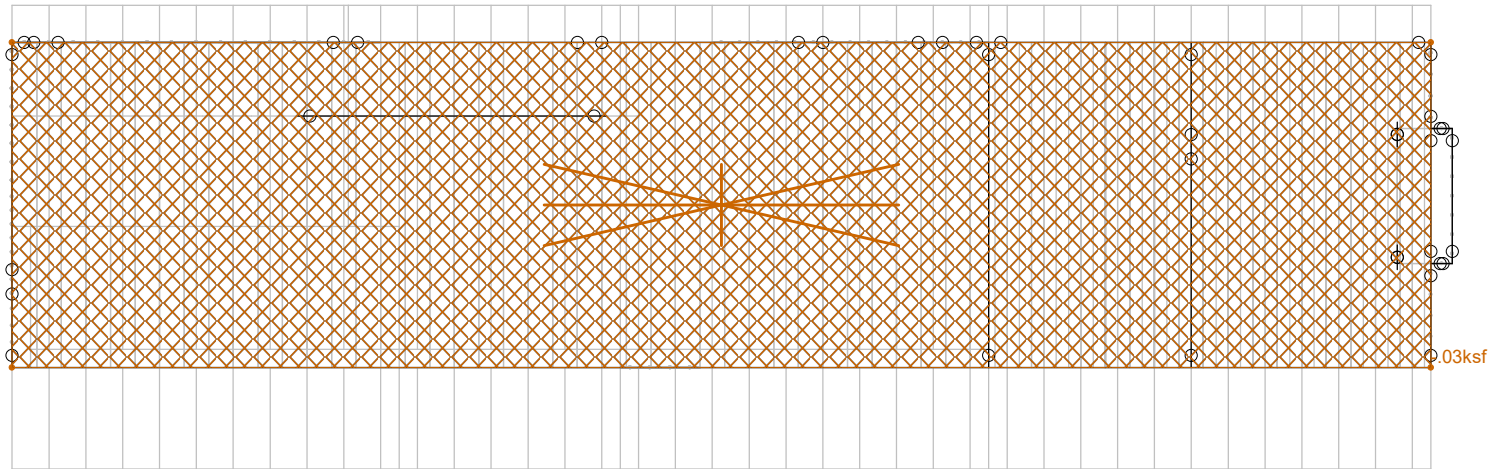

Loads: BLC 1, dead

2nd Floor Dead Load

Main Residence - 8

Mar 18, 2022 at 10:15 AM

mist model 2-26-22.r3d

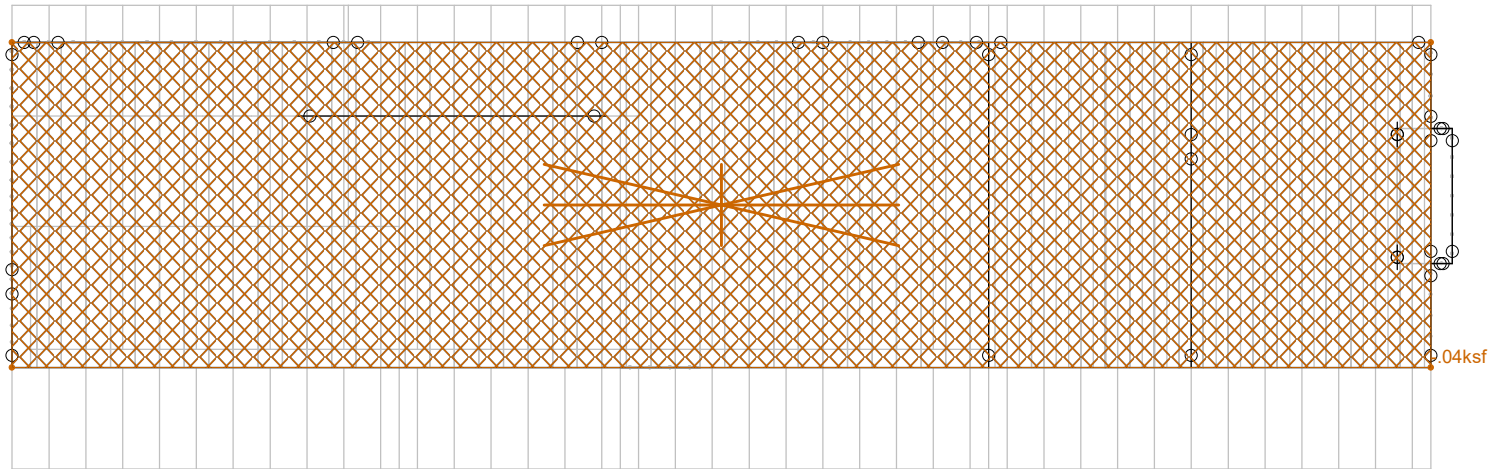

Loads: BLC 7, floor live

2nd Floor Live Load

Main Residence - 9

Mar 18, 2022 at 10:16 AM

mist model 2-26-22.r3d



Code Check
(LC 8)

- No Calc
- > 1.0
- .90-1.0
- .75-.90
- .50-.75
- 0-.50

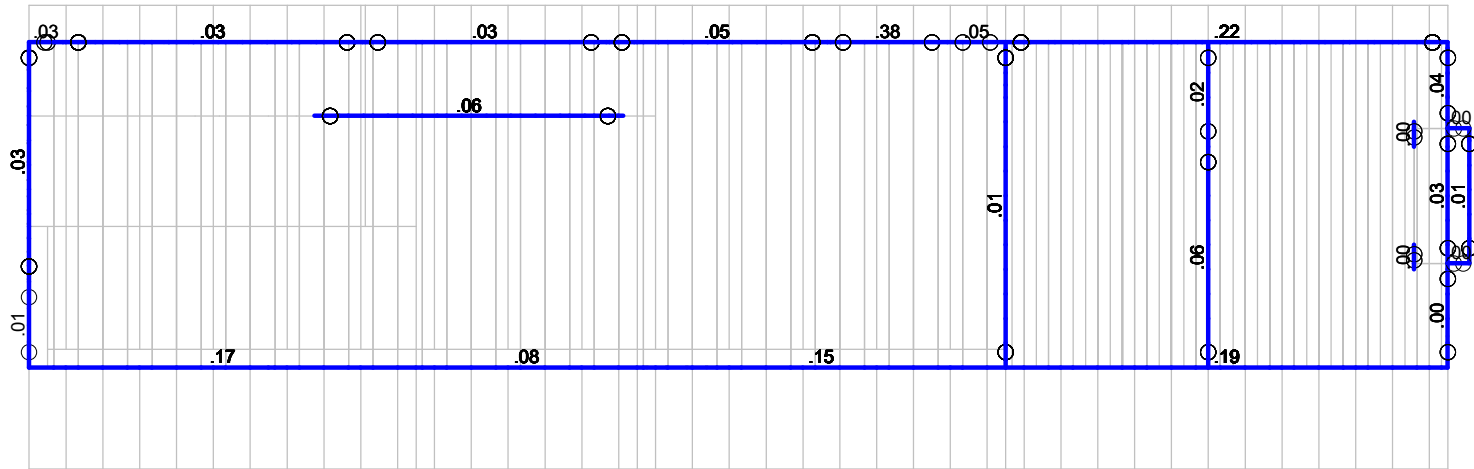

Member Code Checks Displayed
Results for LC 8, d+I

Main Residence - 10

Mar 18, 2022 at 10:18 AM

mist model 2-26-22.r3d

2nd Floor Main Member Stress Check

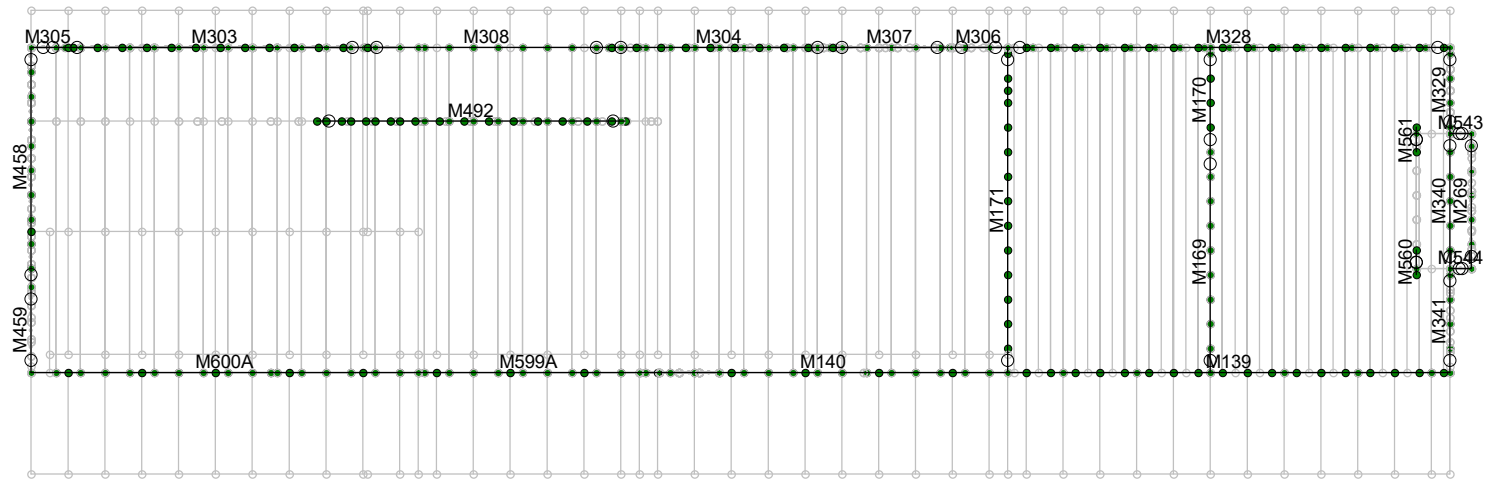

2nd Floor Member Labels

Main Residence - 101

Mar 18, 2022 at 10:36 AM

mist model 2-26-22.r3d

Beam: **M140**
 Shape: **W14X43**
 Material: **A992**
 Length: **20 ft**
 I Joint: **N173**
 J Joint: **N172**
LC 8: d+i
 Code Check: **0.149 (bending)**
 Report Based On 97 Sections

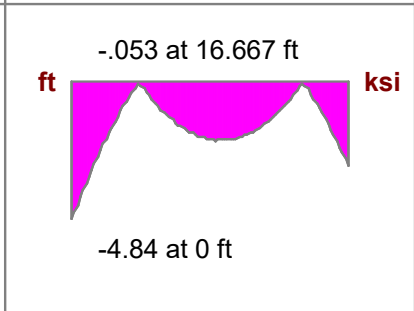
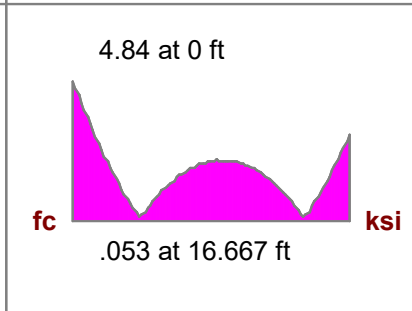
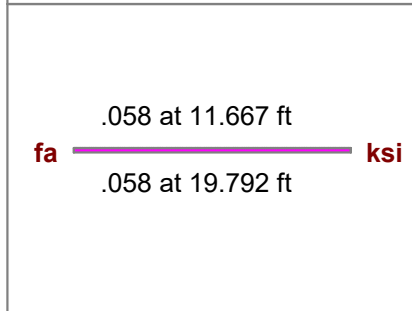
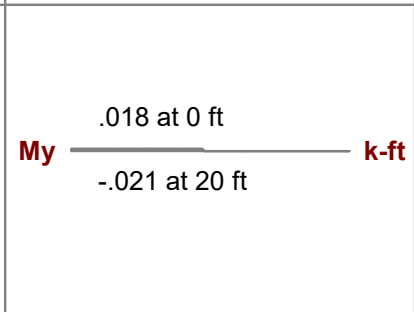
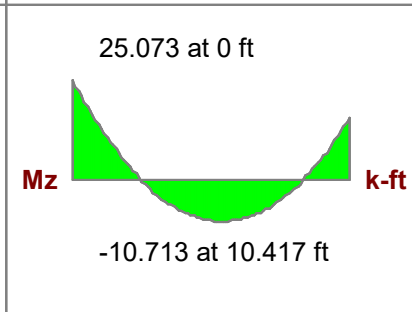
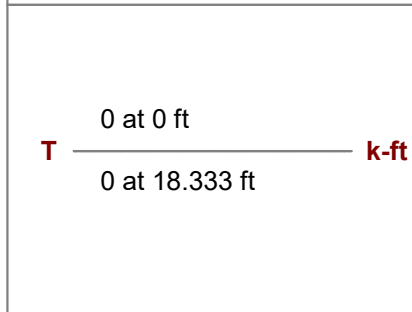
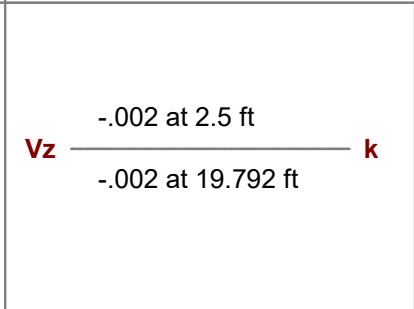
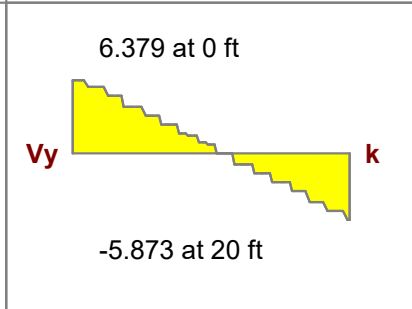
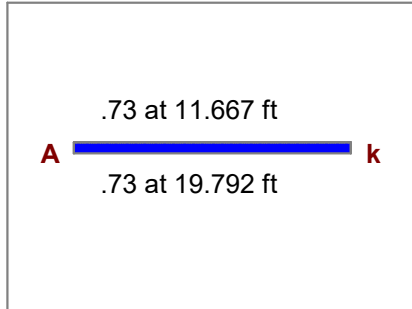
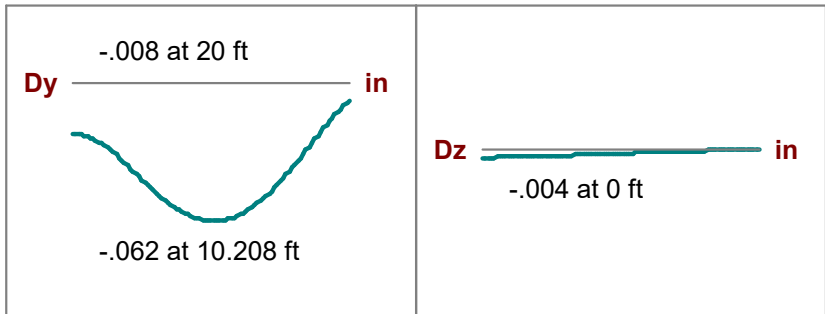

AISC 9th: ASD Code Check

Max Bending Check	0.149	Max Shear Check	0.076 (y)	Max Defl Ratio	L/5126
Location	0 ft	Location	0 ft	Location	10.625 ft
Equation	H1-2			Span	1

Compact

Fy	50 ksi	Cm	.248	z-z	.85
Fa	29.02 ksi	Lb	2 ft		2 ft
Ft	30 ksi	KL/r	12.671		4.118
Fby	37.5 ksi	Sway	No		No
Fbz	33 ksi	L Comp Flange	2 ft		
Fvy	20 ksi				
Fvz	20 ksi				
Cb	1.22				

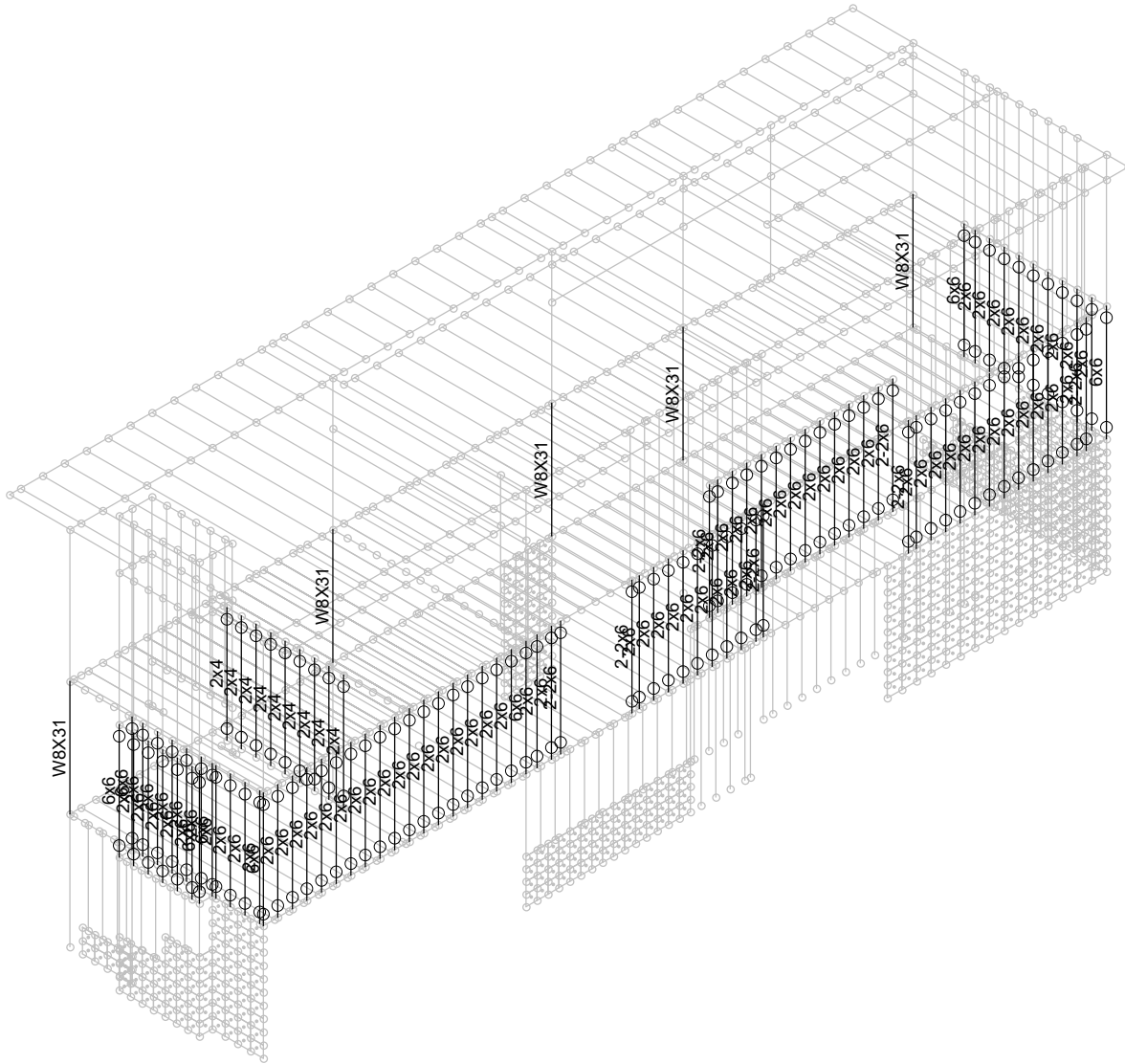
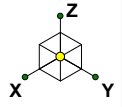

1st to 2nd Floor Column Sizes

Main Residence - 11

Mar 18, 2022 at 10:44 AM

mist model 2-26-22.r3d

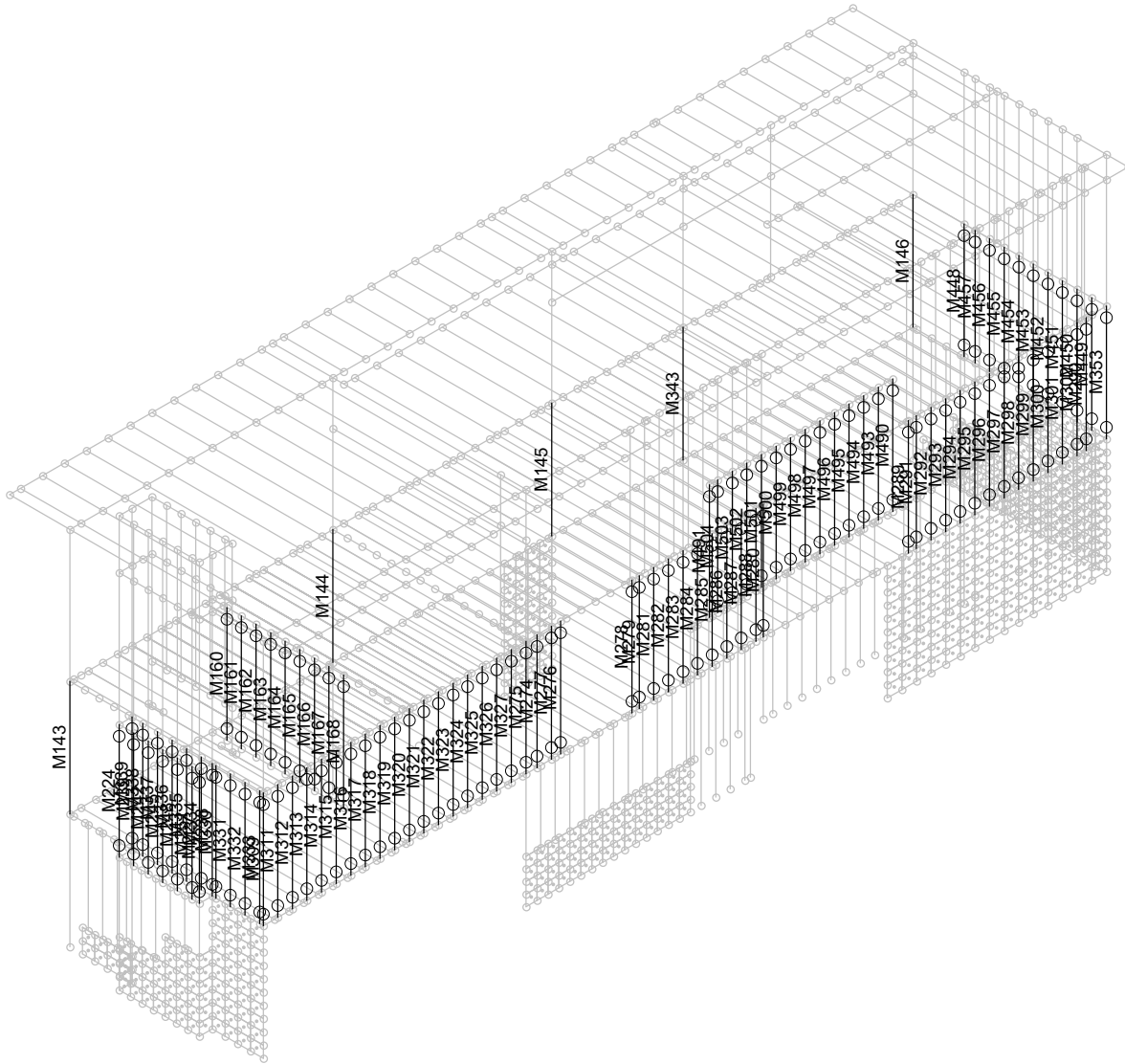
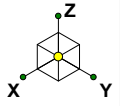

1st to 2nd Floor Column Labels

Main Residence - 111

Mar 18, 2022 at 10:43 AM

mist model 2-26-22.r3d

Column: **M143**

Shape: **W8X31**

Material: **A992**

Length: **10.5 ft**

I Joint: **N192**

J Joint: **N174**

LC 8: d+l

Code Check: **0.226 (bending)**

Report Based On 97 Sections

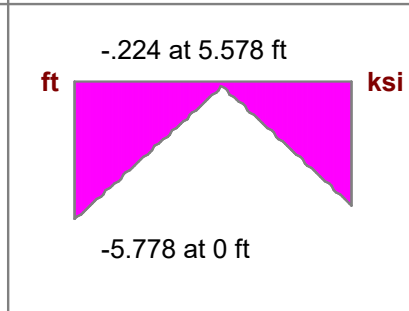
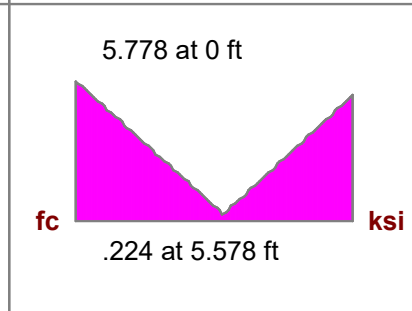
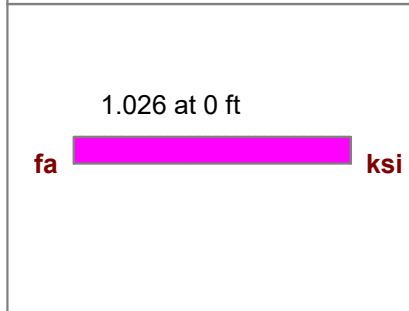
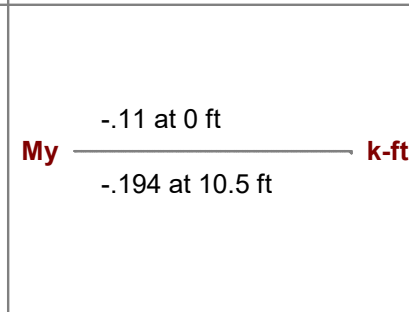
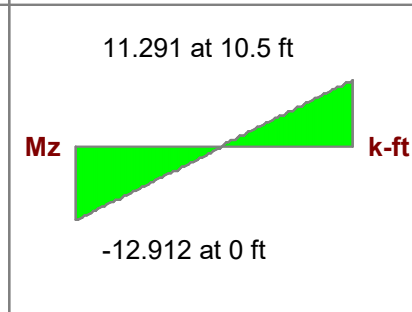
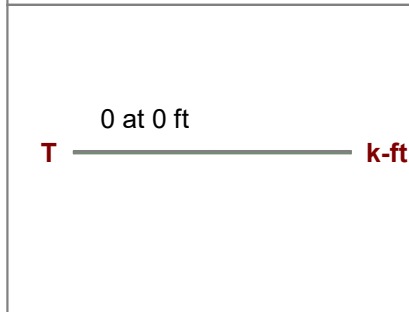
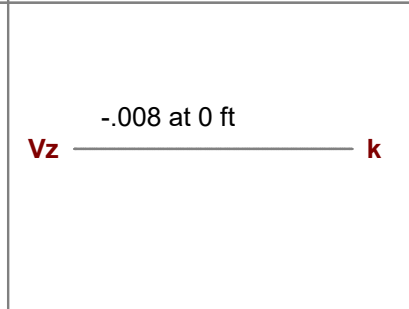
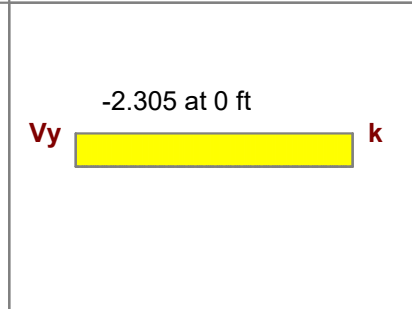
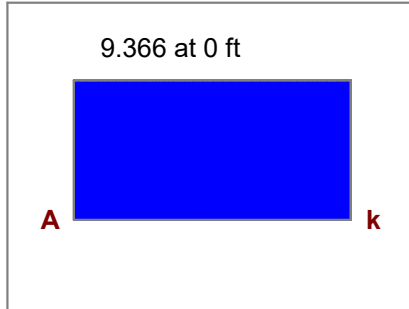
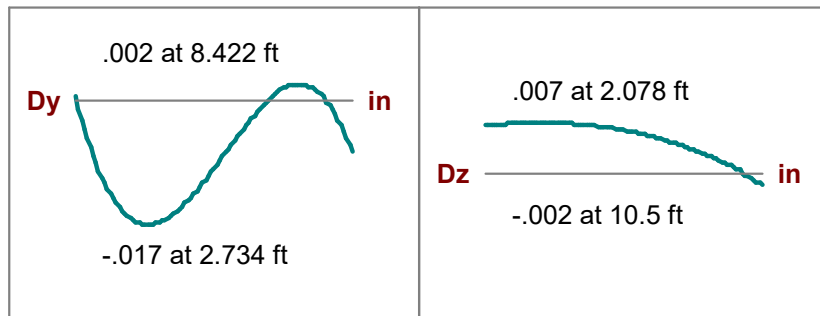

AISC 9th: ASD Code Check

Max Bending Check **0.226**
Location **0 ft**
Equation **H1-2**

Max Shear Check **0.051 (y)**
Location **5.25 ft**
Max Defl Ratio **L/7955**

NonCompact

Fy **50 ksi**
Fa **22.285 ksi**
Ft **30 ksi**
Fby **37.495 ksi**
Fbz **30 ksi**
Fvy **20 ksi**
Fvz **20 ksi**
Cb **2.3**

y-y z-z
Cm **.827** **.25**
Lb **10.5 ft** **10.5 ft**
KL/r **62.506** **36.3**
Sway **No** **No**
L Comp Flange **10.5 ft**

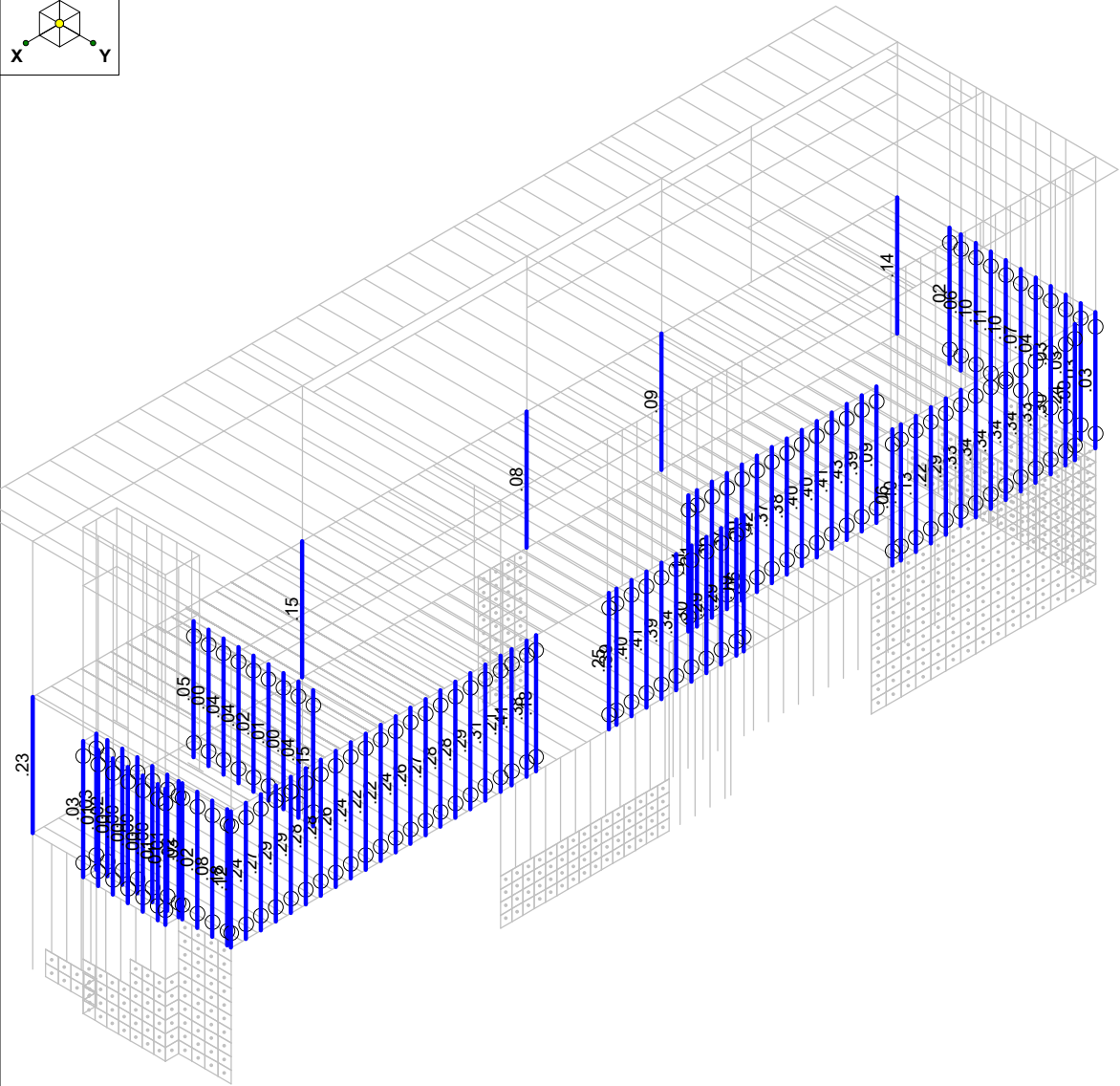
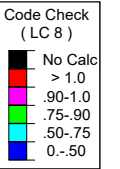
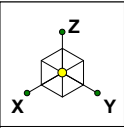

Member Code Checks Displayed
Results for LC 8, d+I

1st to 2nd Floor Column Stress Check

Main Residence - 12

Mar 18, 2022 at 11:14 AM

mist model 2-26-22.r3d

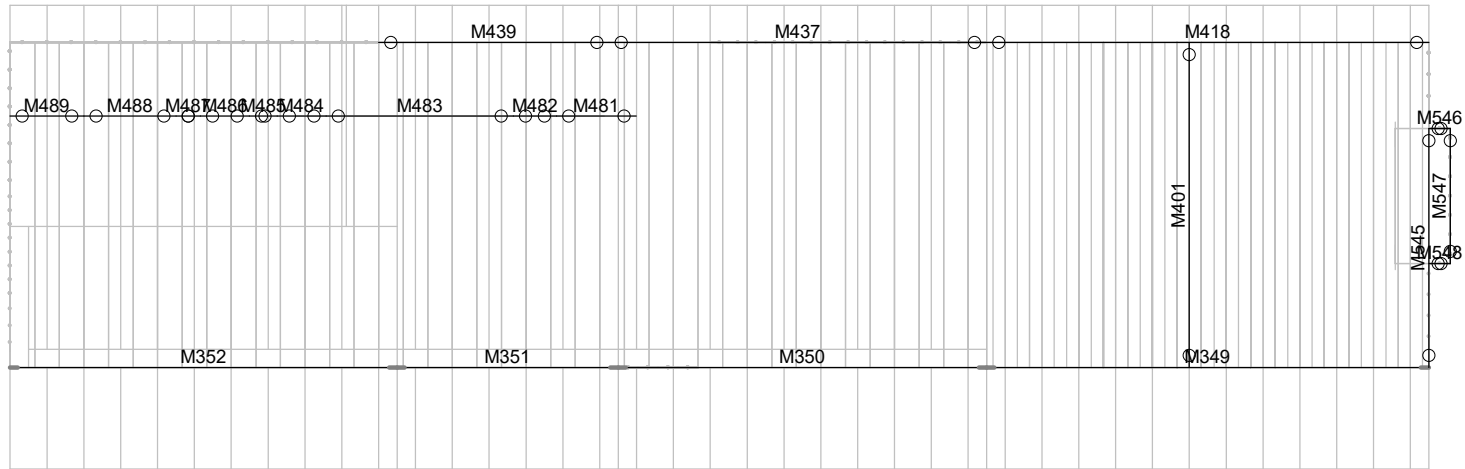

1st Floor Main Member Labels

Main Residence - 131

Mar 18, 2022 at 11:06 AM

mist model 2-26-22.r3d

Beam: **M418**
 Shape: **W16X57**
 Material: **A992**
 Length: **24 ft**
 I Joint: **N423**
 J Joint: **N422**
LC 8: d+l
 Code Check: **0.334 (bending)**
 Report Based On 97 Sections

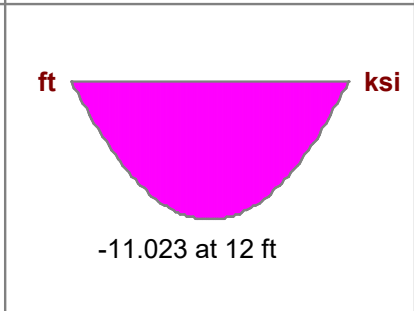
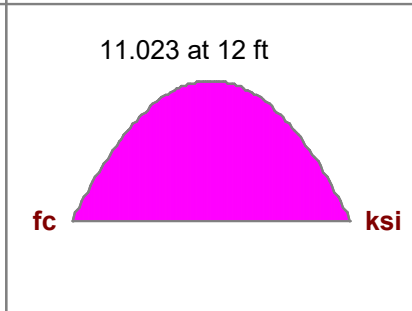
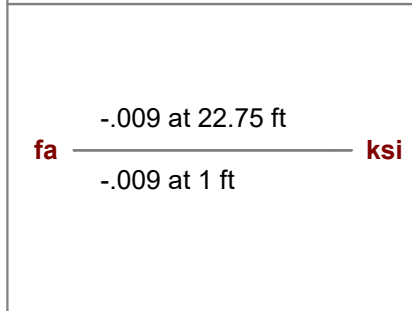
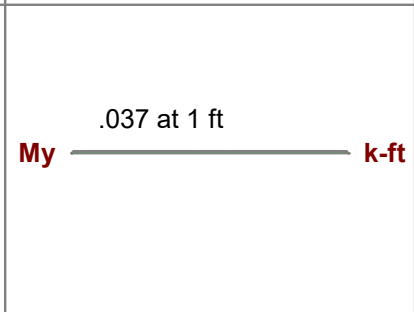
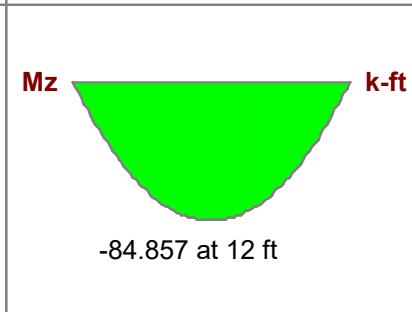
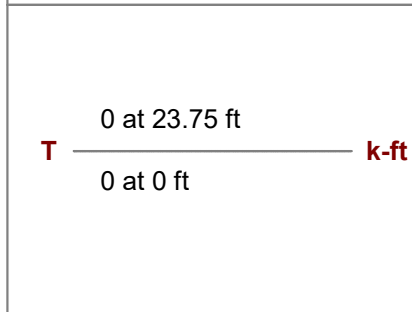
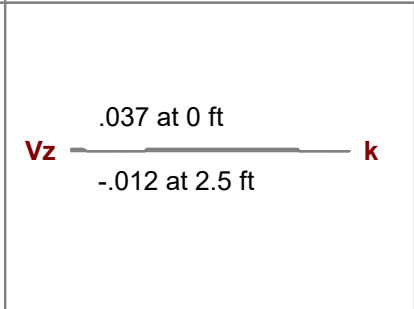
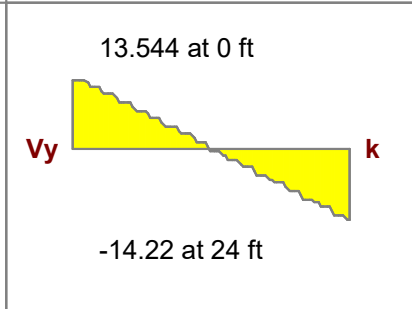
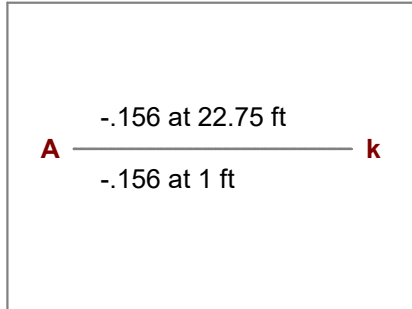
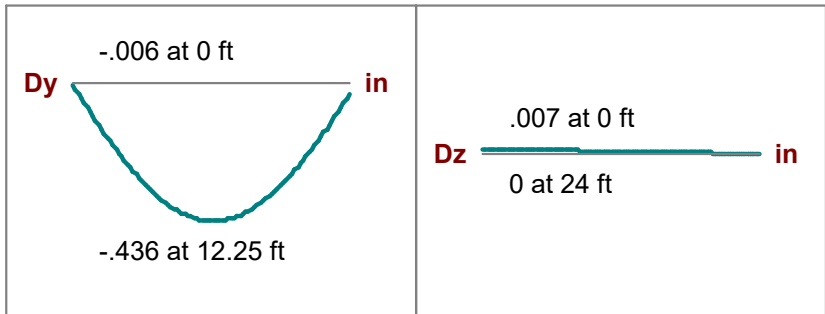

AISC 9th: ASD Code Check

Max Bending Check	0.334	Max Shear Check	0.101 (y)	Max Defl Ratio	L/1359
Location	12 ft	Location	24 ft	Location	3.75 ft
Equation	H2-1			Span	3

Compact

Fy	50 ksi	Cm	.6	z-z	1
Fa	28.804 ksi	Lb	2 ft		2 ft
Ft	30 ksi	KL/r	14.984		3.573
Fby	37.5 ksi	Sway	No		No
Fbz	33 ksi	L Comp Flange	2 ft		
Fvy	20 ksi				
Fvz	20 ksi				
Cb	1				

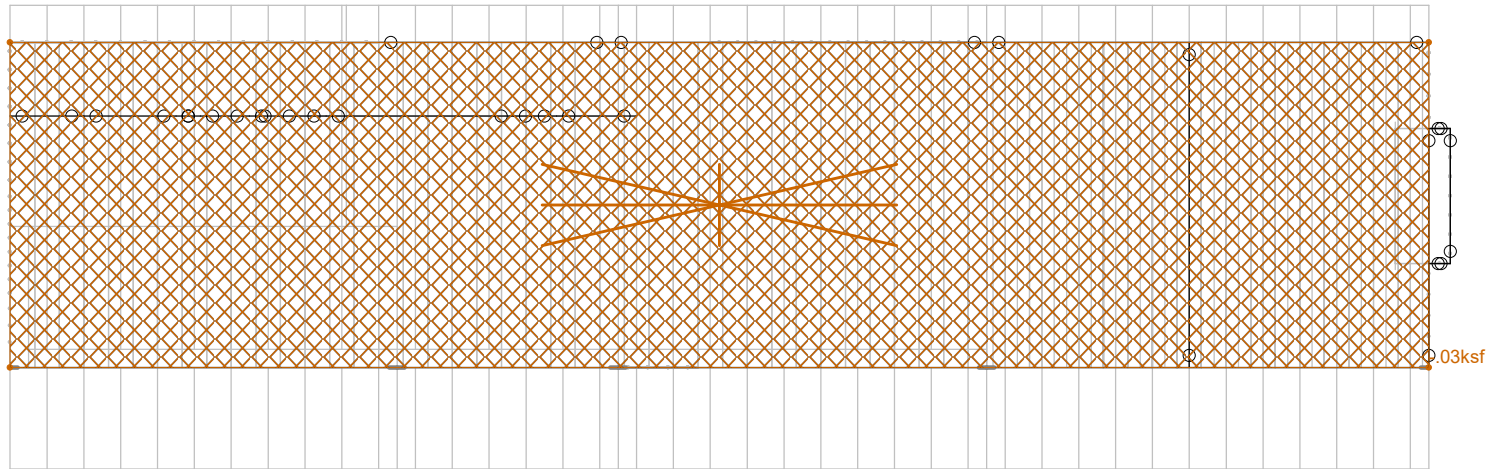

Loads: BLC 1, dead

1st Floor Dead Load

Main Residence - 14

Mar 18, 2022 at 11:08 AM

mist model 2-26-22.r3d

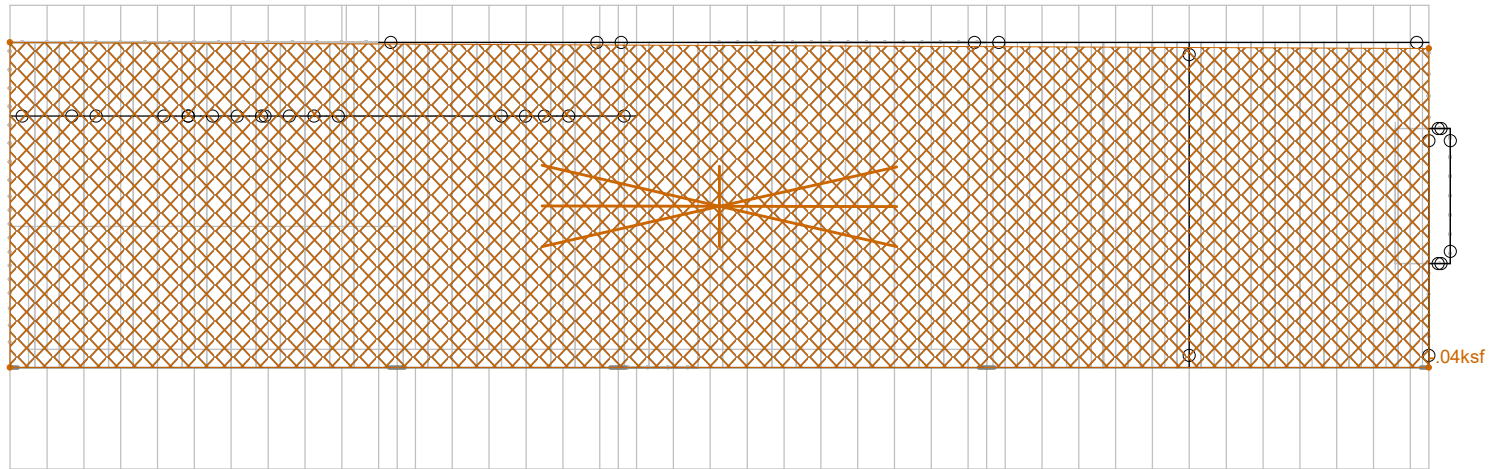

Loads: BLC 7, floor live

1st Floor Live Load

Main Residence - 15

Mar 18, 2022 at 11:09 AM

mist model 2-26-22.r3d



Code Check
(LC 8)

- No Calc
- > 1.0
- .90-1.0
- .75-.90
- .50-.75
- 0.-.50

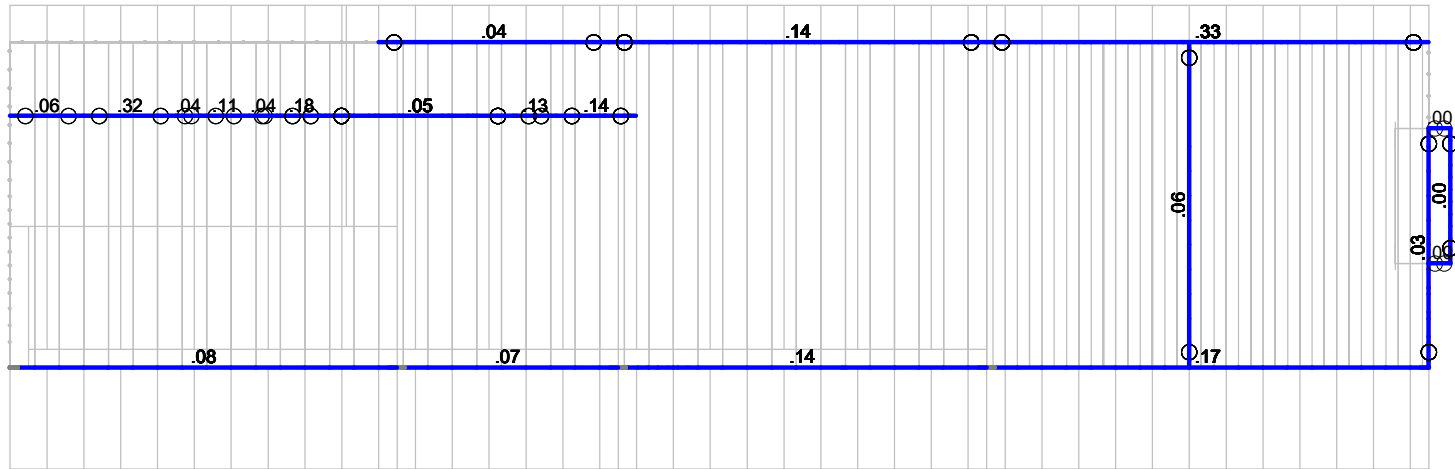

Member Code Checks Displayed
Results for LC 8, d+I

Main Residence - 16

Mar 18, 2022 at 11:10 AM

mist model 2-26-22.r3d

1st Floor Main Members Stress Check

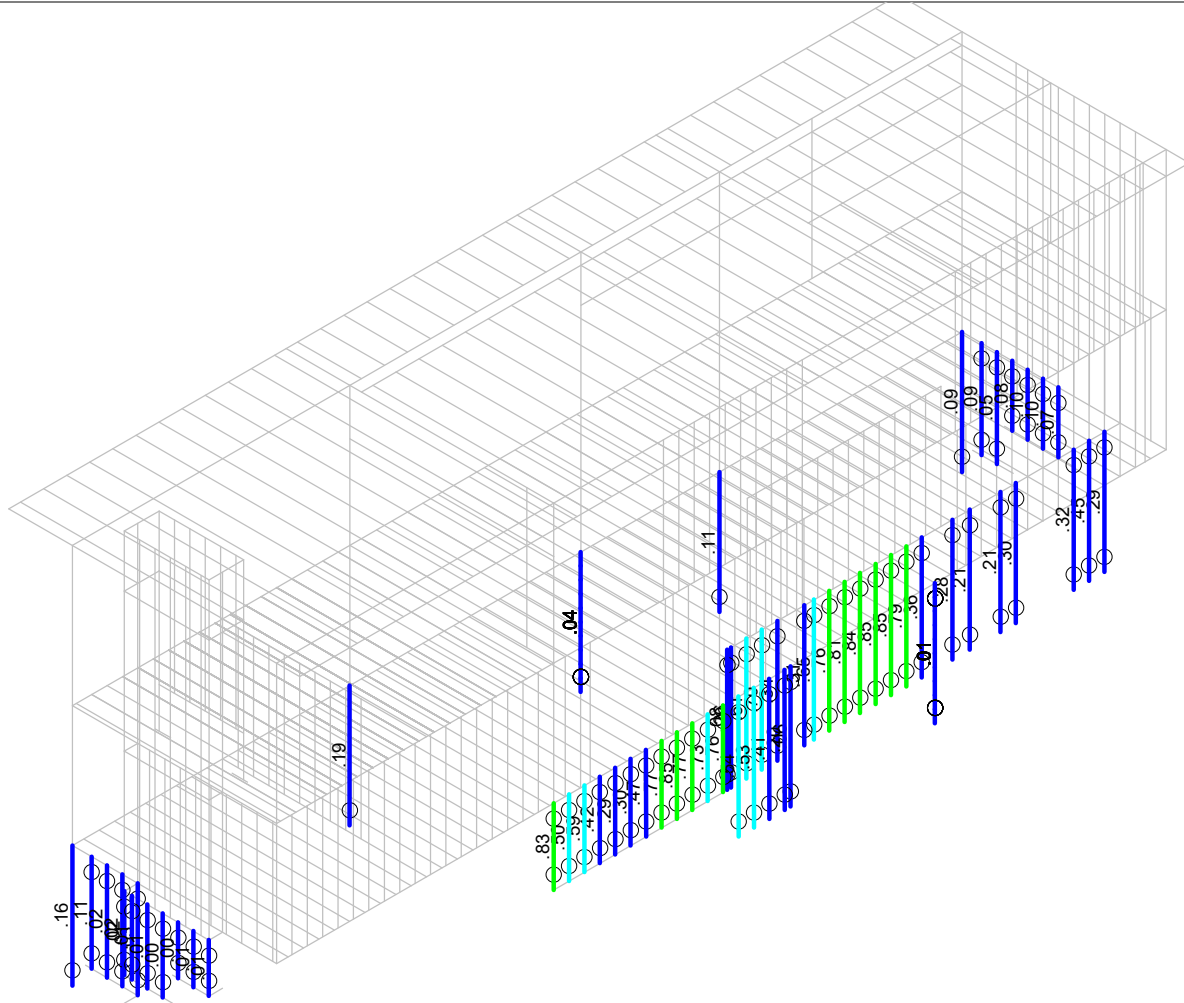
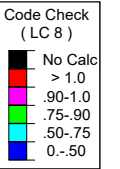
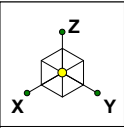

Member Code Checks Displayed
Results for LC 8, d+I

1st Floor Column Stress Check

Main Residence - 162

Mar 18, 2022 at 11:25 AM

mist model 2-26-22.r3d

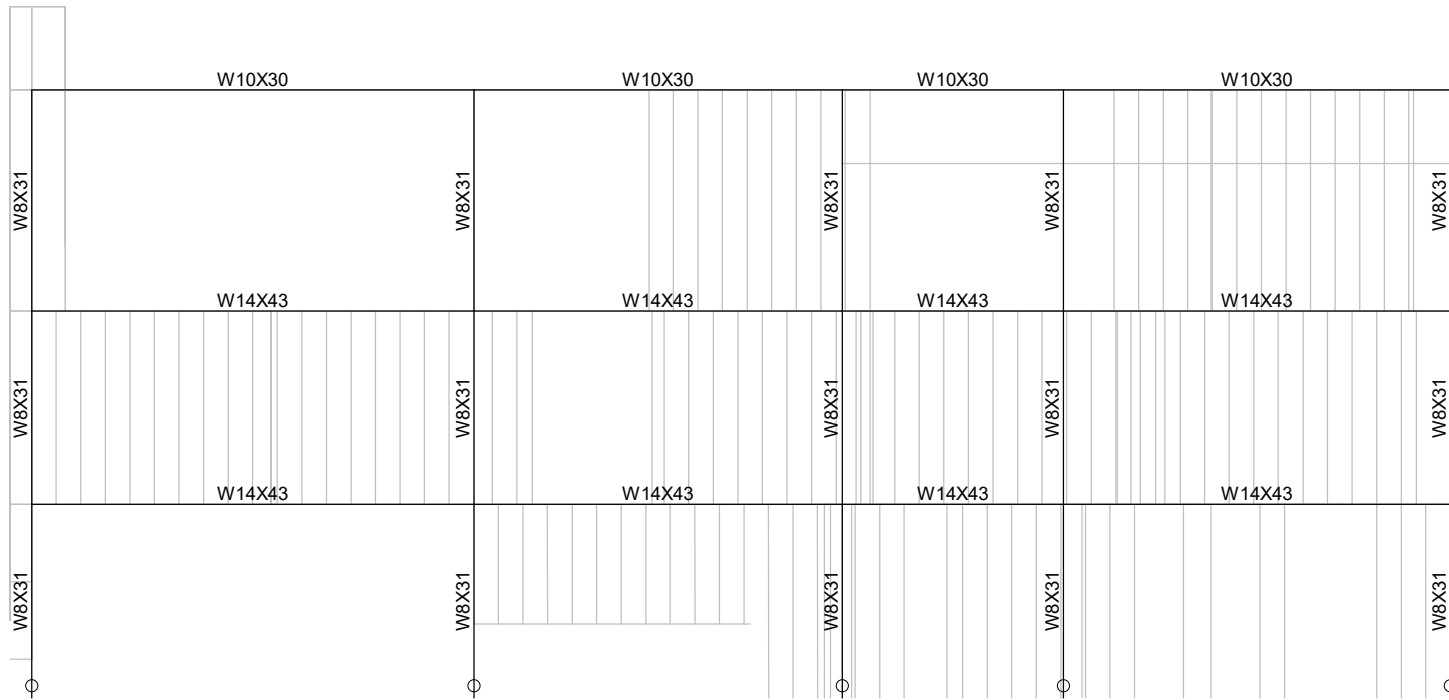

Moment Frame Line A Moment Frame Sizes

Main Residence - 17
Mar 18, 2022 at 11:29 AM
mist model 2-26-22.r3d

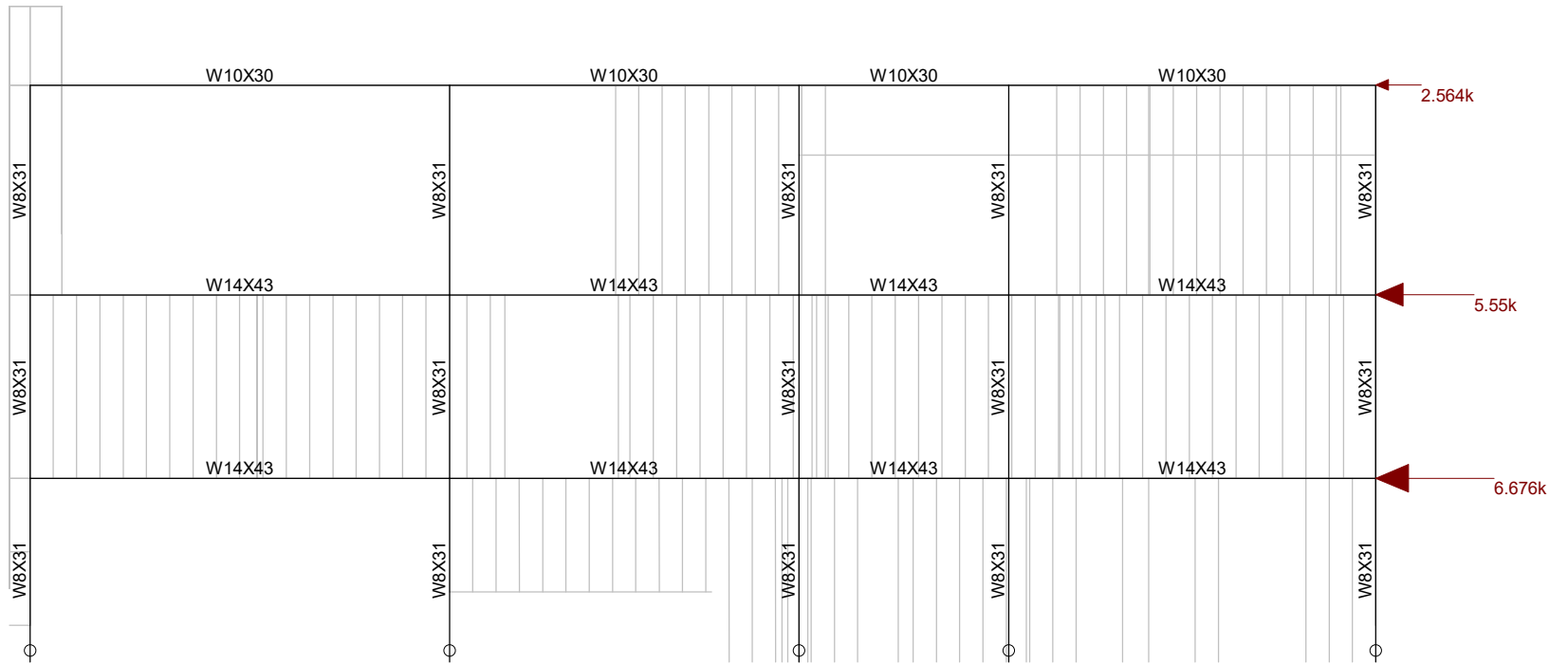

Loads: BLC 3, seismic x

Main Residence - 18

Mar 18, 2022 at 11:30 AM

mist model 2-26-22.r3d

Moment Frame Line A Moment Frame Seismic Loads



Code Check
(LC 2)

- No Calc
- > 1.0
- .90-1.0
- .75-.90
- .50-.75
- 0.-.50

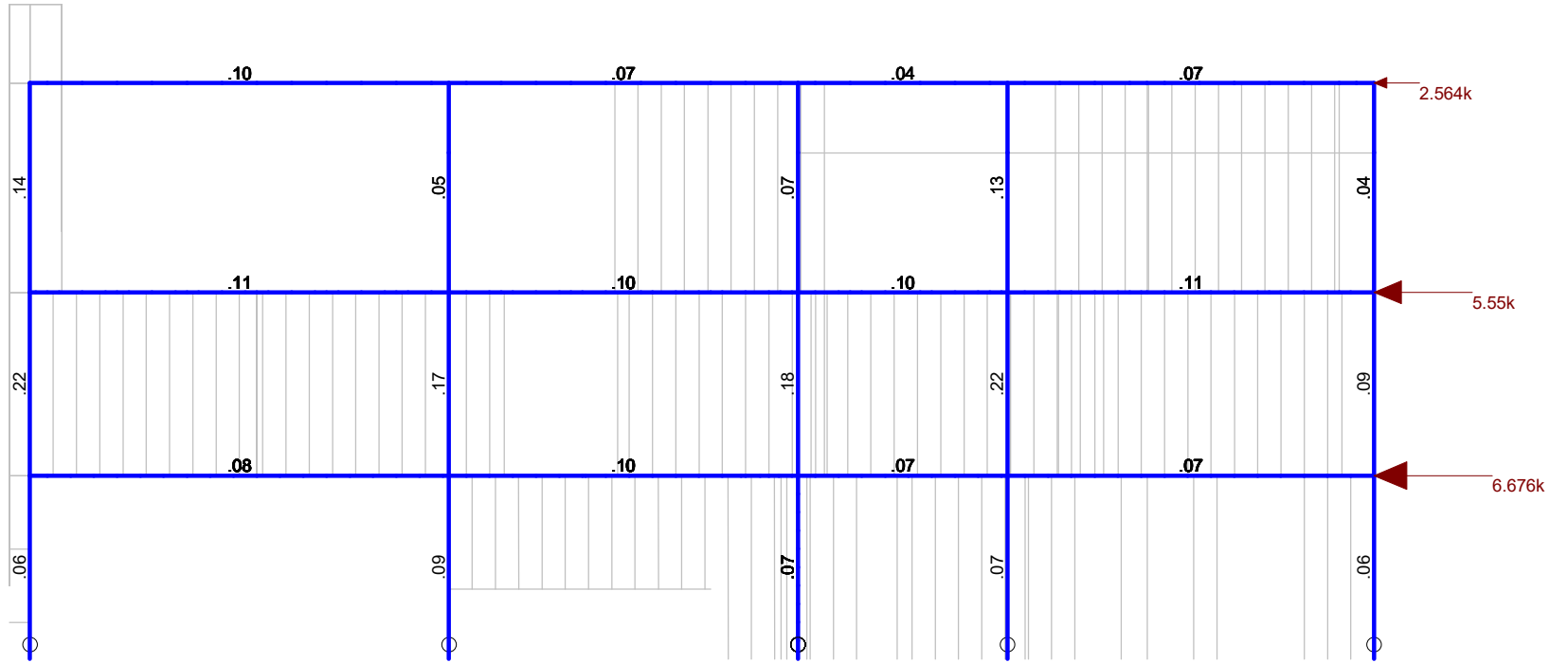

Member Code Checks Displayed
 Loads: BLC 3, seismic x
 Results for LC 2, d+seis x

		Main Residence - 19
		Mar 18, 2022 at 11:32 AM
	Moment Frame Line A Moment Frame Stress Check d+seis x	mist model 2-26-22.r3d



Code Check
(LC 3)

- No Calc
- > 1.0
- .90-1.0
- .75-.90
- .50-.75
- 0.-.50

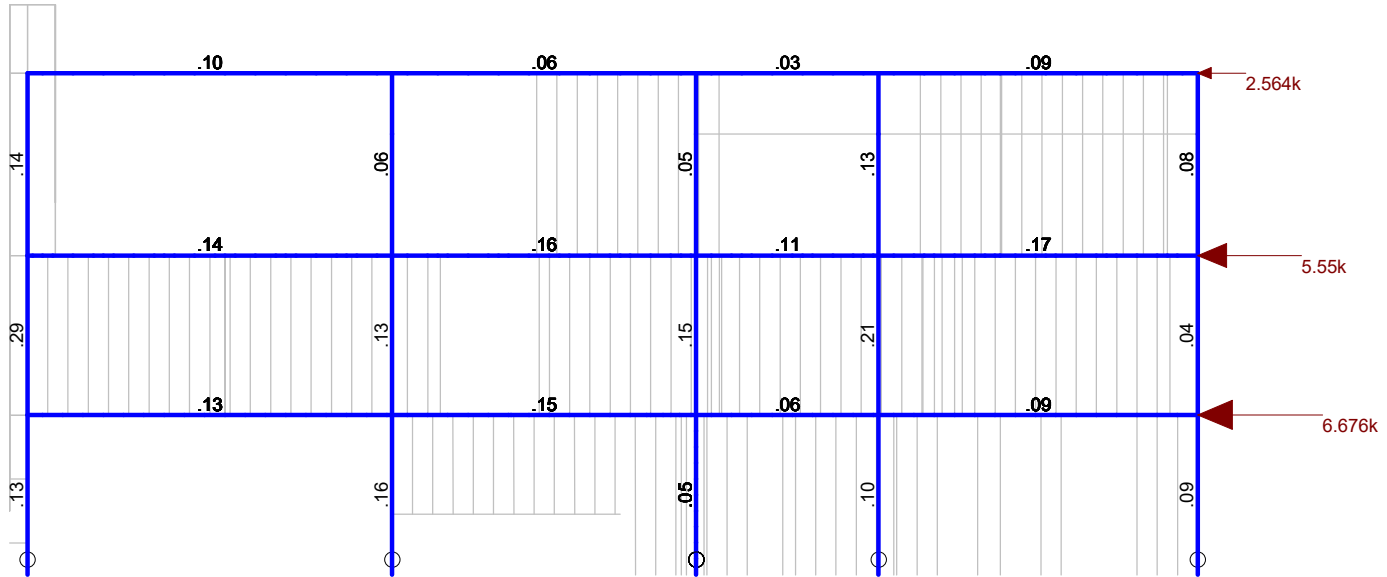

Member Code Checks Displayed
 Loads: BLC 3, seismic x
 Results for LC 3, d+.75l+.75seis x

		Main Residence - 20
		Mar 18, 2022 at 11:36 AM
	Moment Frame Line A Moment Frame Stress Check d+.75L+.75sesi x	mist model 2-26-22.r3d